



Kempsters
ESTATE AGENTS

31 Celedon Close
Chafford Hundred Grays RM16 6PZ



Asking price
£175,000

This immaculate one bedroomed second floor flat has been renovated to a high standard throughout. Features include a bright lounge, recently fitted kitchen, recently fitted shower room, new carpets plus no onward chain.



- Electric Heating
- Double Glazing
- Lounge 14'8 x 11'
- Recently Fitted Kitchen 10'4 x 6'5
- Double Bedroom 11'5 x 9'1
- Recently Fitted Shower Room
- Allocated And Visitor Parking
- No Onward Chain
- New 125 Year Lease

ENTRANCE HALL

Coved and textured ceiling, access to loft space, built-in airing cupboard, wall mounted electric heater, entry phone, power points, fitted carpet.

LOUNGE

14'8 x 11' (4.47m x 3.35m)

Double glazed window to rear, coved and textured ceiling, wall mounted electric heater, power points, fitted carpet. Open plan to:

KITCHEN

10'4 x 6'5 (3.15m x 1.96m)

Textured ceiling, range of base and eye level units with contrasting work surfaces, inset single drainer sink unit, integrated oven, hob and extractor, free standing fridge/freezer, dishwasher and washing machine to remain (if required), partly tiled walls, power points, vinyl flooring.

BEDROOM

11'5 x 9'1 (3.48m x 2.77m)

Double glazed window to rear, coved and textured ceiling, built-in double wardrobe, power points, fitted carpet.

SHOWER ROOM

Textured ceiling, extractor fan, suite comprising shower cubicle, vanity unit with inset wash hand basin and low flush toilet, partly tiled walls, heated towel rail, vinyl flooring.

EXTERIOR

Allocated and visitor parking.

LEASE DETAILS AND SERVICE CHARGES

New 125 year lease to be created

Service Charge £1036 per annum

Ground Rent: £150 per annum











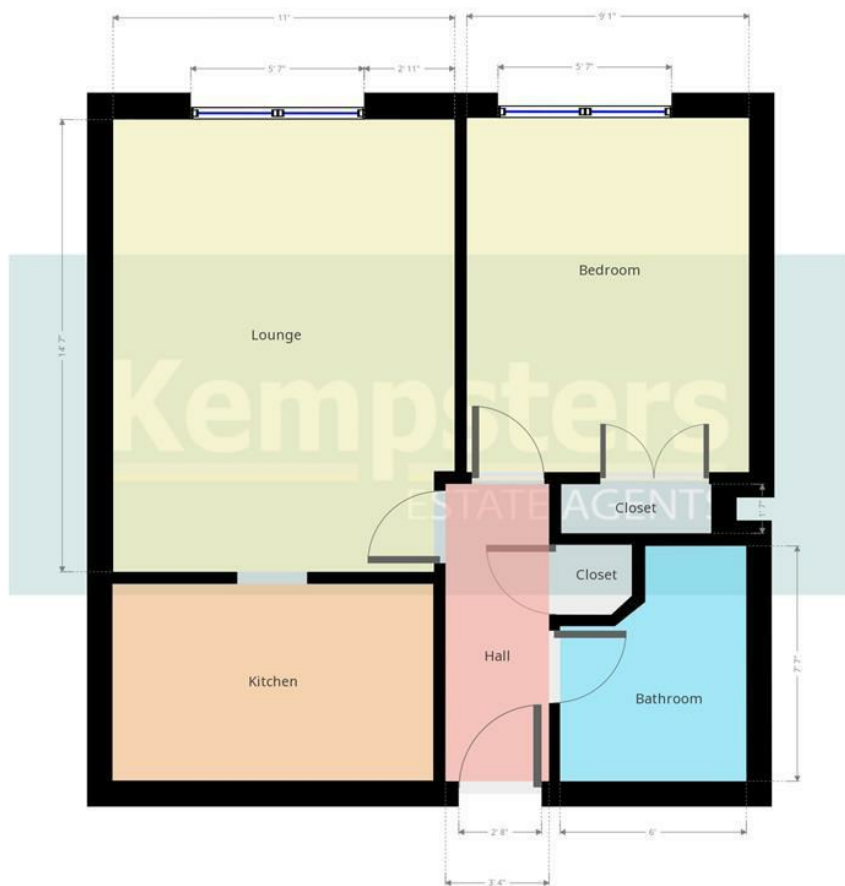

Kempsters Estate Agents take no responsibility for any error, omission, misstatement or use of data shown. This plan is for illustrative purposes only and whilst every attempt has been made to ensure the accuracy of the floorplan shown, all measurements, positioning, fixtures, fittings and any other data shown are an approximate...

Disclaimer: This brochure is for illustrative purposes only and, whilst every attempt has been made to ensure accuracy. Kempsters Estate Agents Ltd take no responsibility for any error, omission, mis-statement or use of any of the information shown. No appliances or main services have been checked.

37 Orsett Road Grays, Essex RM17 5DS • Tel: 01375 394 732 • Email: sales@kempsters.com

