



**Kempsters**  
ESTATE AGENTS

9 Coppid Hall High Road  
North Stifford Grays RM16 5UE



Asking price  
**£165,000**



**This charming GRADE II listed cottage is situated on the edge of North Stifford village and is offered with no onward chain. The property is attached to the main building and was formerly a stable. The property was built in 1756 and was converted to apartments in the 1970's. 360 VIRTUAL TOUR AVAILABLE**



- Electric Heating
- Lounge 14'7 x 13'5
- Kitchen 11'11 max x 6'6
- Mezzanine Area Above Lounge
- Bedroom 7'11 x 7'10
- Bathroom
- Beautiful Communal Gardens
- Allocated And Visitor Parking
- Approx 189 Years Remaining On Lease
- No Onward Chain





## ENTRANCE

Door leads to:

## LOUNGE

14'7 x 13'5 (4.27m'2.13m x 3.96m'1.52m)

French doors to front, wood panelled ceiling, access to mezzanine area (suitable for storage or possibly short term sleeping area), access to loft space, storage heater, power points, laminate floor. Open plan to:

## KITCHEN

11'11 max x 6'6 (3.35m'3.35m max x 1.83m'1.83m)

Window to front, wood panelled ceiling, range of base and eye level units with contrasting work surfaces, inset single drainer sink unit, integrated oven, hob and extractor, space for washing machine, large walk-in storage cupboard, power points.

## INNER LOBBY

Laminate floor.

## BEDROOM

7'11 x 7'10 (2.13m'3.35m x 2.13m'3.05m)

Window to rear overlooking communal gardens, built-in wardrobe, wall mounted electric heater, power point, laminate floor.

## BATHROOM

Opaque glazed window to rear, suite comprising bath, pedestal wash hand basin and low flush toilet, wall mounted electric heater, vinyl flooring.

## EXTERIOR

Extensive and well tended communal gardens. Allocated parking space plus visitor parking.

## LEASE DETAILS AND SERVICE CHARGES

Approximately 189 years remaining on lease.

Service charges: £2043 per annum.





















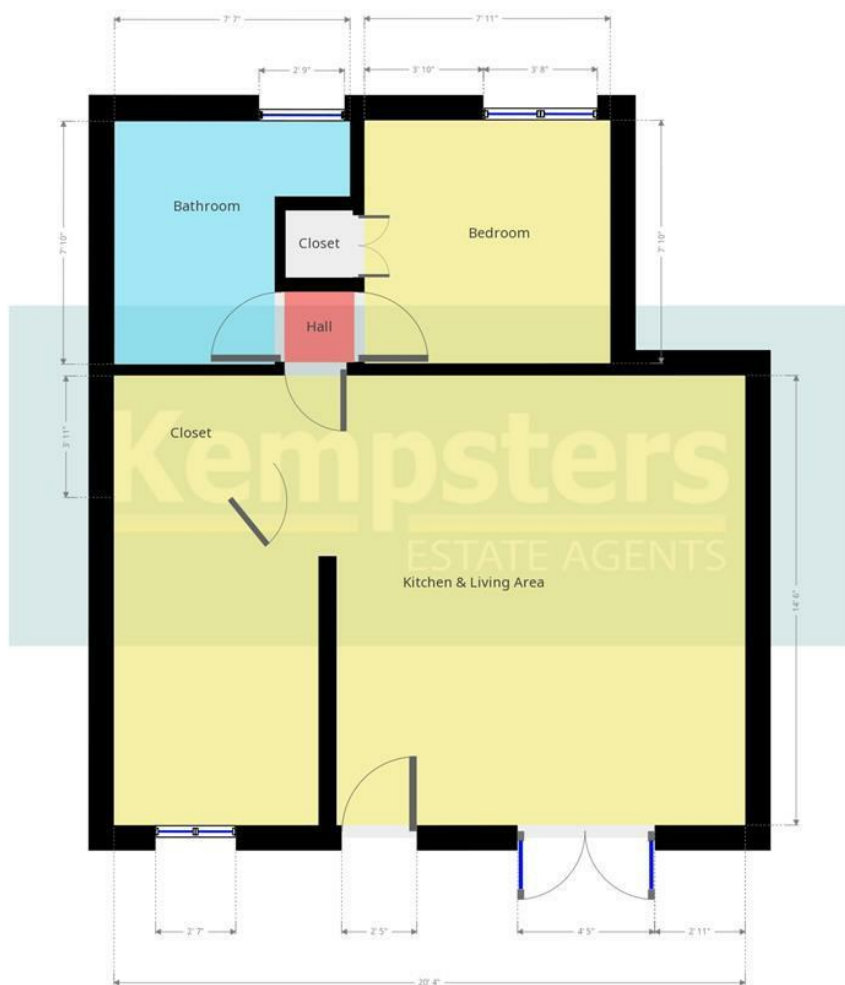

Kempsters Estate Agents take no responsibility for any error, omission, misstatement or use of data shown. This plan is for illustrative purposes only and whilst every attempt has been made to ensure the accuracy of the floorplan shown, all measurements, positioning, fixtures, fittings and any other data shown are an approximate.

Disclaimer: This brochure is for illustrative purposes only and, whilst every attempt has been made to ensure accuracy. Kempsters Estate Agents Ltd take no responsibility for any error, omission, mis-statement or use of any of the information shown. No appliances or main services have been checked.

37 Orsett Road Grays, Essex RM17 5DS • Tel: 01375 394 732 • Email: [sales@kempsters.com](mailto:sales@kempsters.com)

