



Kempsters
ESTATE AGENTS

13 Oak Road
Grays RM17 6JX

2 1 2

Asking price
£219,950

This two bedroom house is situated within easy walking distance of Grays town centre. The property requires modernisation and is offered with no onward chain. 360 VIRTUAL TOUR AVAILABLE.



- Double glazing
- Lounge 12'2 x 9'11
- Dining room 12'2 x 10'2
- Kitchen 13'1 x 7'7
- Bedroom one 12'2 x 9'10
- Bedroom two 10'2 x 9'1
- Bathroom 13'2 x 7'8
- Rear garden
- No onward chain

ENTRANCE PORCH

Double glazed windows to sides, vinyl flooring. Door with opaque glazed inserts leads to:

LOUNGE

12'2 x 9'11 (3.71m x 3.02m)

Double glazed bay window to front, coved and textured ceiling, radiator, power points.

DINING ROOM

12'2 x 10'2 (3.71m x 3.10m)

Double glazed window to rear, coved and textured ceiling, built-in under stairs storage cupboard, radiator, power points.

KITCHEN

13'1 x 7'7 (3.99m x 2.31m)

Double glazed windows to rear and side, half opaque glazed door to side leading to rear garden., range of base and eye level units with contrasting work surfaces, inset single drainer sink unit, ample appliance spaces, radiator, power points, vinyl flooring.

FIRST FLOOR LANDING

Coved and textured ceiling, radiator.

BEDROOM ONE

12'2 x 9'10 (3.71m x 3.00m)

Double glazed window to front, coved and textured ceiling, built-in storage cupboard housing loft access, radiator, power points, laminate floor.

BEDROOM TWO

10'2 x 9'1 (3.10m x 2.77m)

Double glazed window to rear, radiator, power points.

BATHROOM

13'2 x 7'8 (4.01m x 2.34m)

Opaque double glazed window to rear, suite comprising bath with mixer tap and shower attachment, pedestal wash hand basin, low flush toilet and shower cubicle, cupboard housing gas central heating boiler (untested), wall mounted hot water boiler (untested), radiator.

REAR GARDEN

Overgrown and in need of work.

FRONT GARDEN

With wall surround.



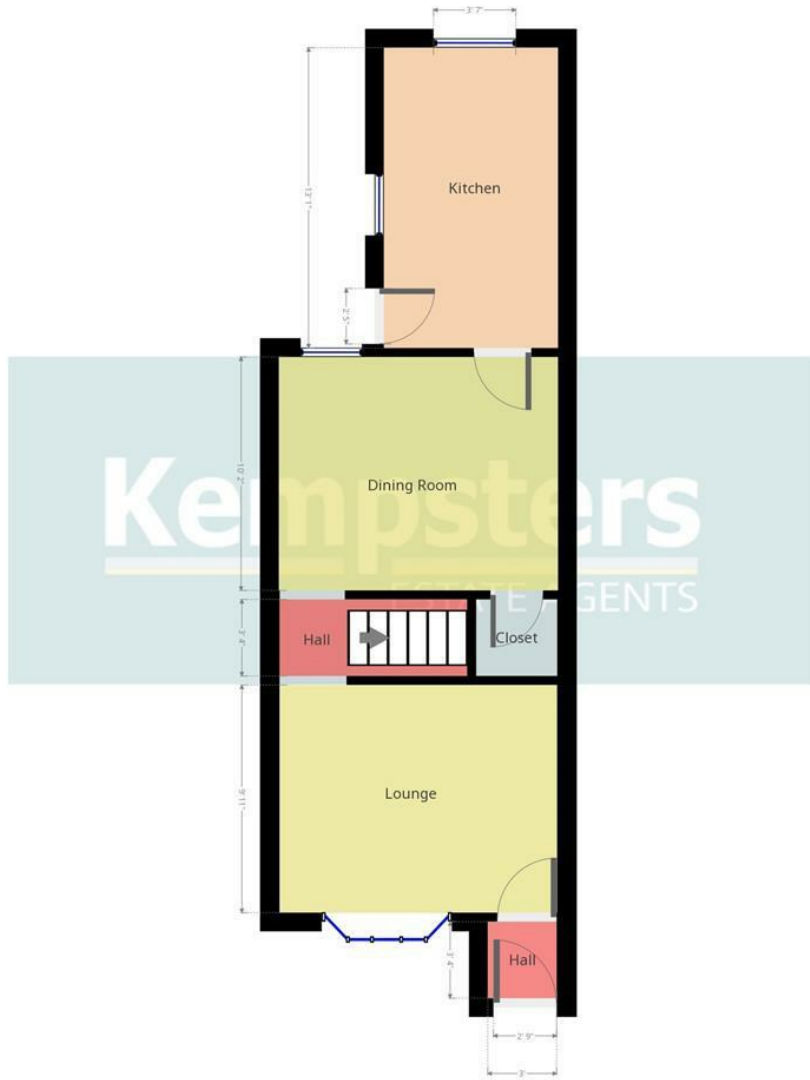

Kempsters Estate Agents take no responsibility for any error, omission, misstatement or use of data shown. This plan is for illustrative purposes only and whilst every attempt has been made to ensure the accuracy of the floorplan shown, all measurements, positioning, fixtures, fittings and any other data shown are an approximate...

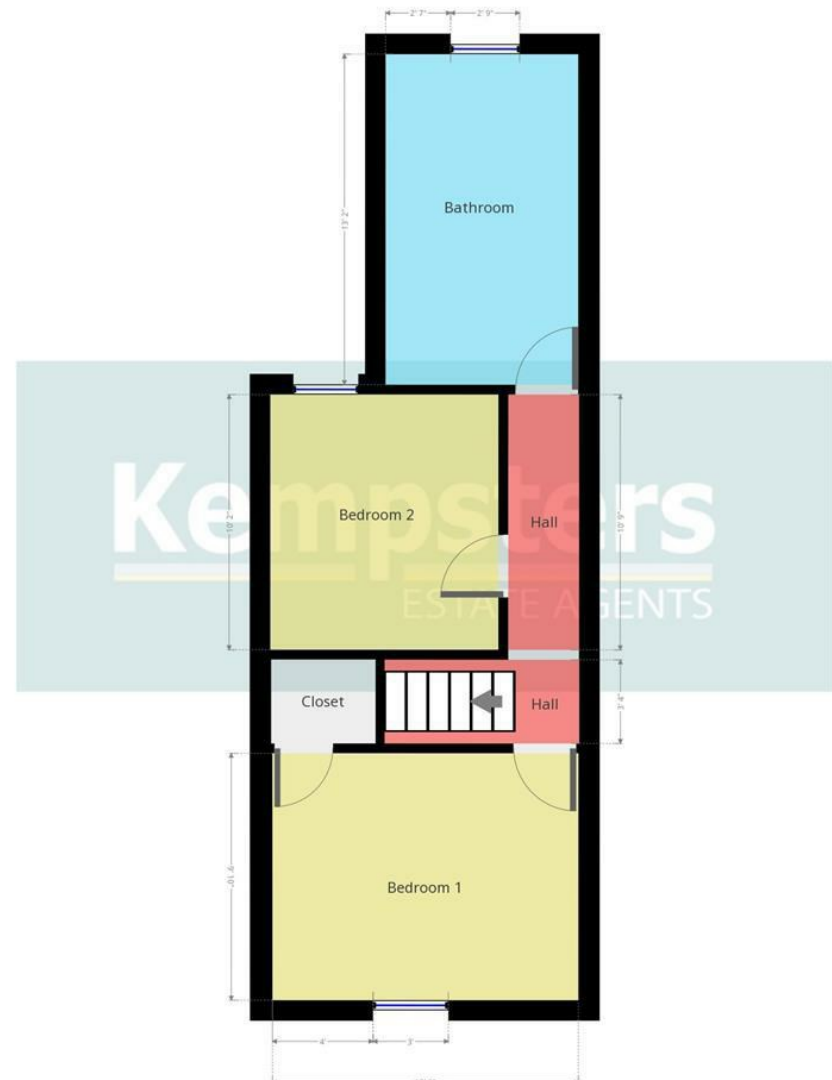

Kempsters Estate Agents take no responsibility for any error, omission, misstatement or use of data shown. This plan is for illustrative purposes only and whilst every attempt has been made to ensure the accuracy of the floorplan shown, all measurements, positioning, fixtures, fittings and any other data shown are an approximate...

Disclaimer: This brochure is for illustrative purposes only and, whilst every attempt has been made to ensure accuracy. Kempsters Estate Agents Ltd take no responsibility for any error, omission, mis-statement or use of any of the information shown. No appliances or main services have been checked.

37 Orsett Road Grays, Essex RM17 5DS • Tel: 01375 394 732 • Email: sales@kempsters.com

