



Kempsters
ESTATE AGENTS

11 Caravel Close
Chafford Hundred Grays RM16 6QB

 2  1  1

Asking price
£199,999

This lovely two bedroomed first floor flat has just been refurbished throughout and is offered with no onward chain. Features include double glazing, new kitchen, new bathroom, communal gardens and allocated parking.



- Electric heating
- Double glazing
- Lounge 12'2 x 10'5
- New fitted kitchen 7'10 x 7'4
- New bathroom
- Bedroom one 11'6 x 8'7
- Bedroom two 10'4 x 7'1
- Loft storage space
- Communal gardens
- Allocated parking

ENTRANCE HALL

Textured ceiling, entry phone, storage heater, built-in cupboard housing water tank, power point, laminate floor.

LOUNGE

12'2 x 10'5 (3.71m x 3.18m)

Two double glazed windows to rear, textured ceiling, storage heater, power points, laminate floor.

NEW FITTED KITCHEN

7'10 x 7'4 (2.39m x 2.24m)

Double glazed window to front, textured ceiling, extractor fan, range of base and eye level units with contrasting work surfaces, inset single drainer sink unit, integrated oven, hob and extractor, space for fridge/freezer and washing machine, partly tiled walls, wall mounted electric heater, power points, tiled floor.

BEDROOM ONE

11'6 x 8'7 (3.51m x 2.62m)

Double glazed window to rear, textured ceiling, storage heater, power points, laminate floor.

BEDROOM TWO

10'4 x 7'1 (3.15m x 2.16m)

Double glazed window to front, textured ceiling, access to loft space, power points, fitted carpet.

NEW BATHROOM

Opaque double glazed window to front, textured ceiling, suite comprising bath with mixer tap and shower attachment, vanity unit with inset wash hand basin and low flush wc, tiling to three walls, wall mounted electric heater, tiled floor.

EXTERIOR

Communal gardens. Allocated parking.

LEASE DETAILS AND SERVICE CHARGES

Approximately 100 years remaining on lease

Service charges: Approximately £100 per month

Ground rent: TBA







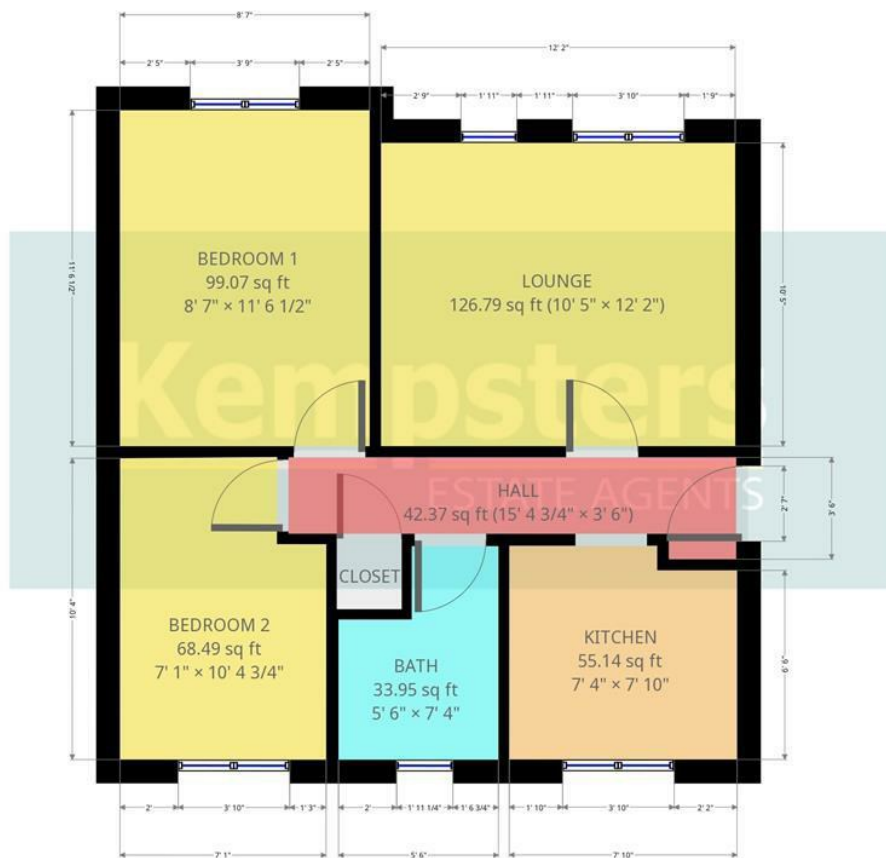

Kempsters Estate Agents take no responsibility for any error, omission, misstatement or use of data shown. This plan is for illustrative purposes only and whilst every attempt has been made to ensure the accuracy of the floorplan shown, all measurements, positioning, fixtures, fittings and any other data shown are an approximate interpretation...

Disclaimer: This brochure is for illustrative purposes only and, whilst every attempt has been made to ensure accuracy. Kempsters Estate Agents Ltd take no responsibility for any error, omission, mis-statement or use of any of the information shown. No appliances or main services have been checked.

37 Orsett Road Grays, Essex RM17 5DS • Tel: 01375 394 732 • Email: sales@kempsters.com

