



Kempsters
ESTATE AGENTS

95 Devereux Road
Chafford Hundred Grays RM16 6PB

1 1 1

Offers in the region of
£185,000

This outstanding one bedroomed ground floor flat comes with its own private garden, lovely fitted kitchen with integrated appliances, bright lounge, stylish bathroom, double bedroom with fitted wardrobes and allocated parking space.



- Lounge 12'6 x 12'2
- Fitted kitchen 13'1 x 5'7 with integrated appliances
- Bedroom 13'1 x 8'9 with fitted wardrobe
- Stylish bathroom
- Private rear garden
- Allocated parking space
- Long lease
- No service charges

ENTRANCE

Door with opaque double glazed insert leads to:

SMALL ENTRANCE HALL

Coved and textured ceiling, fitted carpet. Glazed door leads to:

LOUNGE

12'6 x 12'2 (3.81m x 3.71m)

Double glazed window to front, textured ceiling, storage heater, power points, fitted carpet.

INNER HALLWAY

Coved and textured ceiling, built-in airing/storage cupboard, fitted carpet.

BATHROOM

Textured ceiling, suite comprising bath with independent shower unit above, wash hand basin and low flush wc, extractor fan, wall mounted electric heater, tiled walls, fitted carpet.

FITTED KITCHEN

13'1 x 5'7 (3.99m x 1.70m)

Double glazed window and half double glazed door leads to rear garden, coved and textured ceiling, range of base and eye level units with contrasting work surfaces, inset single drainer sink unit, integrated oven, hob, canopy with extractor, fridge/freezer, washing machine and dishwasher, part tiling to two walls, wall mounted electric heater, power points, tiled floor.

BEDROOM

13'1 x 8'9 (3.99m x 2.67m)

Double glazed window to rear, coved and textured ceiling, storage heater, power points, fitted carpet.

REAR GARDEN

Laid to patio with shrub and tree borders, timber shed, outside light, outside tap. Side pedestrian access leading through to front. One allocated parking space at front.

LEASE DETAILS



In excess of 970 years remaining on lease
No service charges





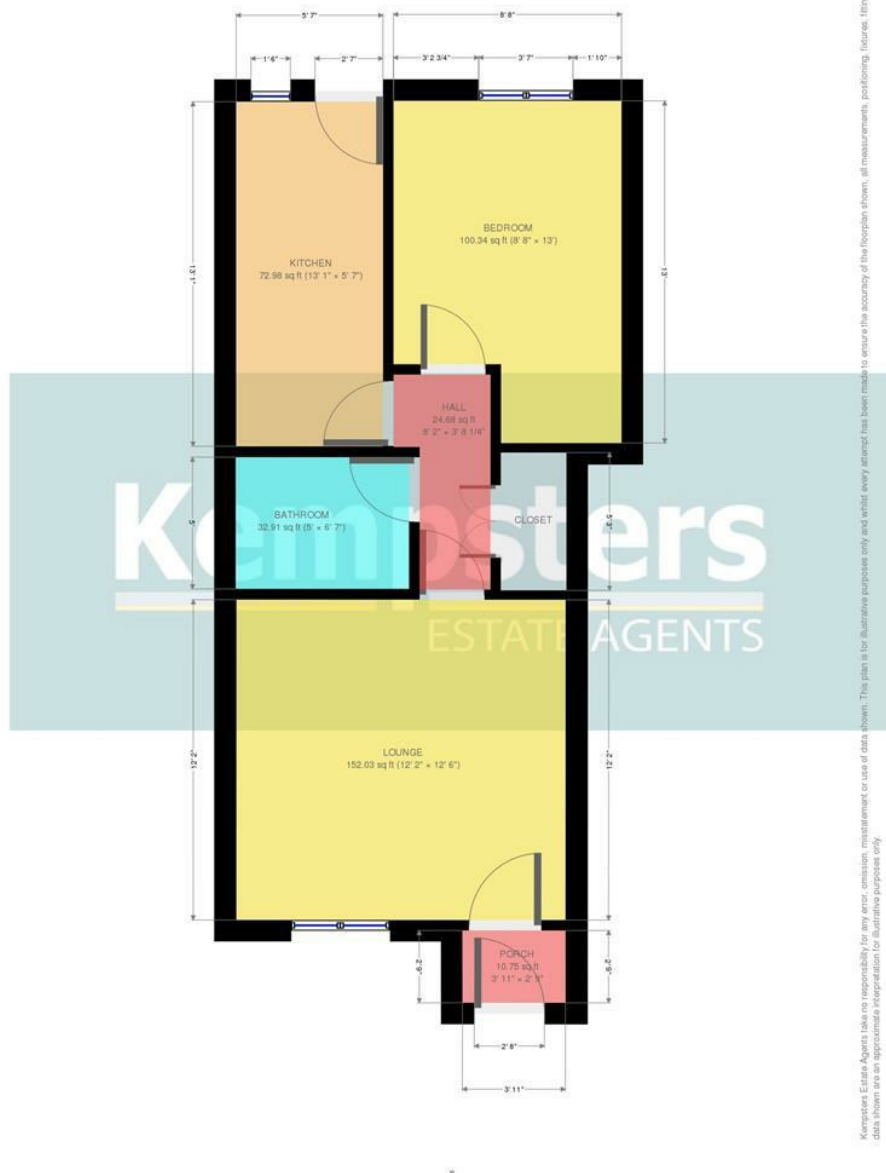

Kempsters Estate Agents takes no responsibility for any error, omission, misstatement or use of data shown. This plan is for illustrative purposes only and whilst every attempt has been made to ensure the accuracy of the floorplan shown, all measurements, positioning, fixtures, fittings and any other data shown are an approximate representation for illustrative purposes only.

Disclaimer: This brochure is for illustrative purposes only and, whilst every attempt has been made to ensure accuracy. Kempsters Estate Agents Ltd take no responsibility for any error, omission, mis-statement or use of any of the information shown. No appliances or main services have been checked.

37 Orsett Road Grays, Essex RM17 5DS • Tel: 01375 394 732 • Email: sales@kempsters.com

